

Features

- Operating Modes: Virtual Com, Serial Tunnel, TCP Server, TCP Client, UDP and Modbus Gateway
- Support 1xRS-232/422/485 in DB9 connector
- Redundant multiple host devices:
5 host devices: Virtual COM, TCP Server, TCP Client mode;
4 IP ranges: UDP
- Security: SSL data encryption; secured management by HTTPS and SSH: IP Access: IP White List
- Event Warning by Syslog, Email, SNMP trap
- Configurable by Web-based and Windows utility (**DS-Tool**)
- Various Windows O.S. supported:
Windows NT/2000/ XP/ 2003/VISTA(32/64bit)/ Windows 7(32/64bit)

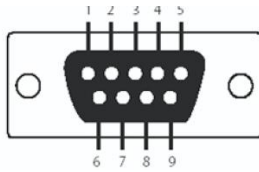

Pin Definition



DB9 connector

Pin #	RS-232	RS-422	RS-485 (4 wire)	RS-485 (2 wire)
1	DCD	TX-	TX-	
2	RXD	TX+	TX+	
3	TXD	RX+	RX+	DATA+
4	DTR	RX-	RX-	DATA-
5	GND	GND	GND	GND
6	DSR			
7	RTS			
8	CTS			

DIP Switch

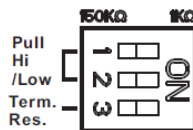

SW No.	Description
# 1	150K / 1K Ohm Pull High/Low Resistor
# 2	
# 3	Enable / Disable Terminal Resistor

Dimension

Unit: mm

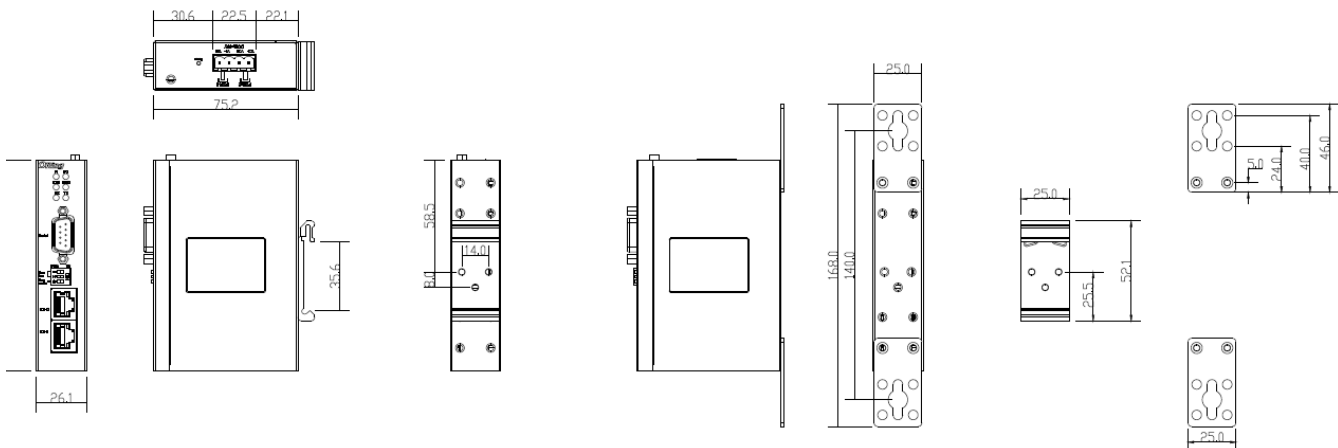

Specifications

ORing Device Server Model	IDS-312L
Physical Ports	
10/100 Base-T(X) Ports in RJ45 Auto MDI/MDIX	2
Serial Ports	
Connector	DB9 x 1
Operation Mode	RS-232/422/485
Serial Baud Rate	110 bps to 921.6 Kbps
Data Bits	7, 8
Parity	odd, even, none, mark, space
Stop Bits	1, 1.5, 2
RS-232	TxD, RxD, RTS, CTS, DTR, DSR, DCD, GND
RS-422	Tx-, Tx+, Rx+, Rx-
RS-485	4 wire: Tx-, Tx+, Rx+, Rx- 2 wire: Data-, Data+
Flow Control	XON/XOFF, RTS/CTS, DTR/DSR
Network Protocol	
Protocol	ICMP, IP, TCP, UDP, DHCP, BOOTP, SSH, DNS, SNMP V1/V2c, HTTPS, SMTP
LED indicators	
Power indicator	2 x LEDs, PWR 1(2) / Ready: Green On: Power is on
10/100TX RJ45 port indicator	Green for port Link/Act at 100Mbps.
Serial TX / RX LEDs:	Amber: Serial port is receiving data Green: Serial port is transmitting data
Power	
Redundant Input power	Dual DC inputs. 12-48VDC on 4-pin terminal block
Power consumption (Typ.)	1.44 W
Overload current protection	Present
Reverse polarity protection	Present
Physical Characteristic	
Enclosure	IP-30
Dimension (W x D x H)	26 (W) x 75 (D) x 110 (H) mm
Weight (g)	227g
Environmental	
Storage Temperature	-40 to 85°C (-40 to 185°F)
Operating Temperature	-40 to 70°C (-40 to 158°F)
Operating Humidity	5% to 95% Non-condensing
Regulatory approvals	
EMI	FCC Part 15B, CISPR 32 (EN55032 Class A)
EMS	EN61000-4-2 (ESD), EN61000-4-3 (RS), EN61000-4-4 (EFT), EN61000-4-5 (Surge), EN61000-4-6 (CS), EN61000-4-8, EN61000-4-11
Shock	IEC60068-2-27
Free Fall	IEC60068-2-32
Vibration	IEC60068-2-6
Safety	EN60950-1
Warranty	5 years

Ordering Information

IDS-3**ABL**

Code Definition	Serial Port Type	Serial Port Number	10/100Base-T(X) port Number
Option	- 1: RS-232 - 2: RS-422/485 - 3: RS-232/422/485	- 1: 1ports	- 2: 2 ports

Available Model	Model Name	Description
	IDS-312L	Industrial 1 secure serial port to Ethernet device server with 1xRS-232/422/485 and 2x10/100Base-T(X)

Packing List

- IDS-312L x 1
- Wall-Mount Kit x 2
- CD x 1
- Din-Rail Kit x 1
- Quick Installation Guide x 1

Optional Accessories

- DR-45 series : 45 Watts power supply
- DR-120 series : 120 Watts power supply
- DR-75 series : 75 Watts power supply