

Features

- Leading EN50155-compliant wireless access point for rolling stock application
- High Speed Air Connectivity: WLAN interface support up to 300 Mbps link speed
- Highly Security Capability: WEP/WPA/WPA-PSK(TKIP,AES)/WPA2/WPA2-PSK(TKIP,AES)/802.1X Authentication supported
- **Support X-Roaming < 60ms**
- Support external SMA antenna installation
- Support AP/Client /Bridge /AP-Client Mode
- **Support Multiple-SSID to 4 SSID**
- Support MAC Filter
- Dual Gigabit Ethernet ports support Ethernet redundant mode (Recovery time < 10ms) and switch mode in M12 connector (A-coding)
- Wireless connecting status monitoring
- 1KV isolation for PoE P.D. port for TGAP-620+-M12
- Secured Management by HTTPS
- Event Warning by Syslog, Email, SNMP Trap, and Relay output
- Rigid IP-40 housing design
- Wall-mount enabled



TGAP-620+-M12

IP-67/ EN50155 Wireless Access Point

Dimension

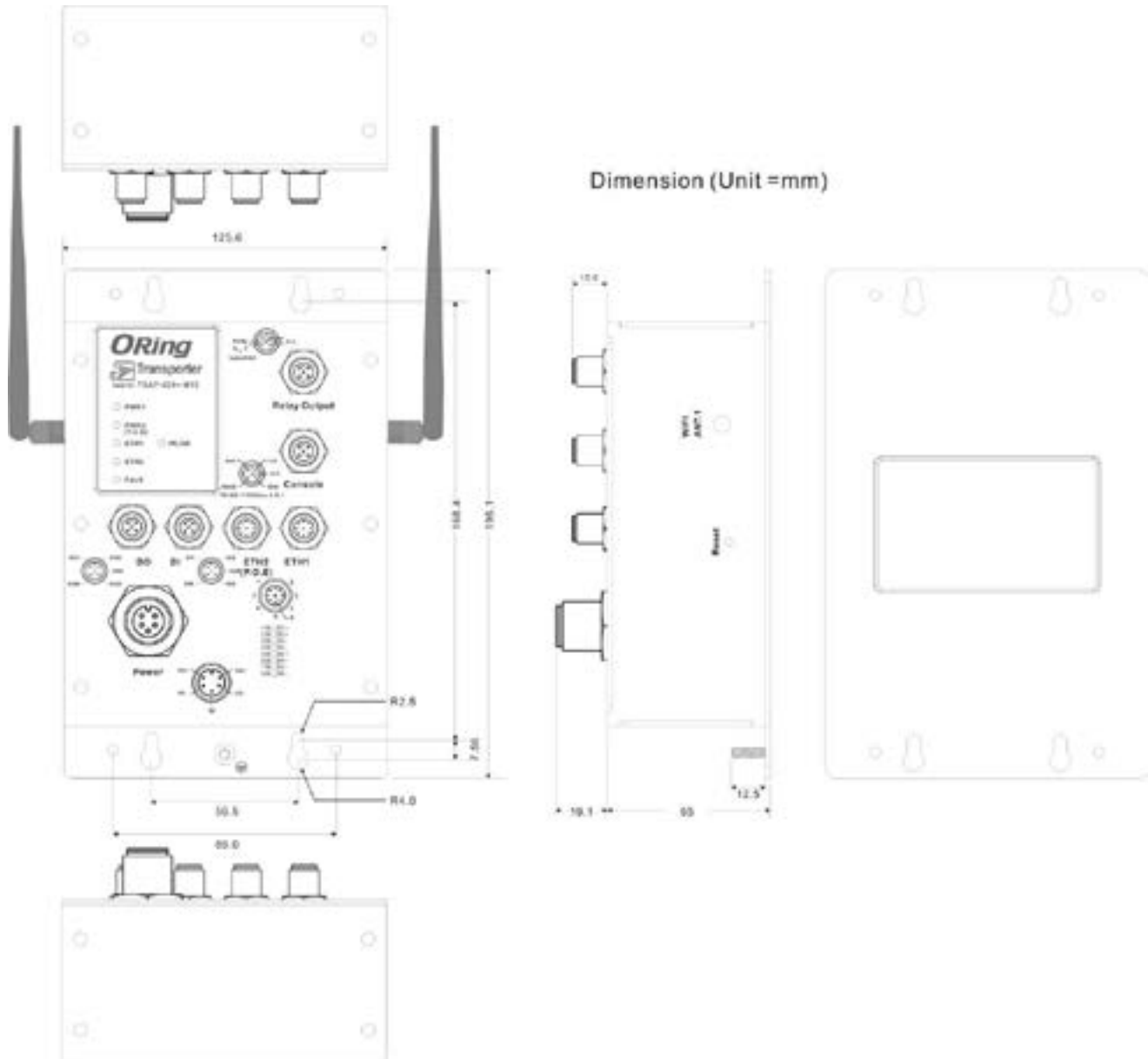

Specifications

ORing WLAN Access Point Model	TGAP-620-M12	TGAP-620+-M12
Physical Ports		
10/100/1000Base-T(X) Ports in M12 Auto MDI/MDIX (8-pin A-coding)	2	2 (Present at ETH2 Fully compliant with IEEE 802.3af PoE P.D)
DIDO port in M12 (5-pin A-coding)	2(DI x 4 and DO x 4) : Dry Contact: On: short to GND, Off: open Wet Contact (DI to COM/GND): On: 0 to 3VDC, Off: 10 to 30VDC	
RS-232 Console port in M12 (5-pin A-coding)	115200, 8 ,N ,1	
Relay port in M12 (5-pin A-coding)	1A@24VDC	
WLAN Interface		
Operating Mode	AP/Bridge/Client/AP-Client	
Antenna Connector	2 x External reverse SMA-type antenna connector	
Radio Frequency Type	OFDM, DSSS	
Modulation	IEEE802.11b: CCK/DQPSK/DBPSK IEEE802.11a/g: OFDM IEEE802.11n: BPSK, QPSK, 16-QAM, 64-QAM	
Frequency Band	America/FCC: 2.412~2.462 GHz (11 channels) 5.180~5.240 GHz & 5.745~5.825 GHz (9 channels) Europe CE/ETSI: 2.412~2.472 GHz (13 channels) 5.180~5.240 GHz (4 channels)	
Transmission Rate	802.11b: 11, 5.5, 2, 1 Mbps; 802.11g: 54, 48, 36, 24, 18, 12, 9, 6 Mbps 802.11n: up to 300Mbps	
Transmit Power	802.11a: 12dBm ± 1.5dBm@54Mbps 802.11b: 17dBm ± 1.5dBm@11Mbps 802.11g: 16dBm ± 1.5dBm@54Mbps 802.11gn HT20: 15dBm ± 1.5dBm @MCS7 802.11gn HT40: 14dBm ± 1.5dBm @MCS7 802.11an HT20: 12dBm ± 1.5dBm @MCS7 802.11an HT40: 11dBm ± 1.5dBm @MCS7	
Receiver Sensitivity	802.11a : -76dBm ± 2dBm@54Mbps 802.11b : -85dBm ± 2dBm@11Mbps 802.11g : -76dBm ± 2dBm@54Mbps 802.11gn HT20:-75dBm ± 2dBm@MCS7 802.11gn HT40:-72dBm ± 2dBm@MCS7 802.11an HT20:-74dBm ± 2dBm@MCS7 802.11an HT40:-71dBm ± 2dBm@MCS7	
Encryption Security	WEP: (64-bit ,128-bit key) WPA/WPA2 PSK :TKIP and AES encryption (802.11i) 802.1X/RADIUS Authentication supported	
Wireless Security	SSID broadcast disable and enable	
Protocol Support		
Protocol	ARP,BOOTP, DHCP, DNS, HTTP, IP, ICMP, SNMP, TCP, UDP, RADIUS, SNMP, STP, RSTP,	
LED Indicators		
Power Indicator	2 x LEDs, PW1:Green for DC Power on PW2:Green for DC Power on or power by PoE	
10/100/1000Base-T(X) Indicator	2 x LEDs, Green for port Link/Act	
WLAN LED	1 x LED, Green for WLAN Link/Act	
Fault	1 x LED, Red for Ethernet link down or power down indicator	
Fault Contact		
Relay	Relay output to carry capacity of 1A at 24VDC(5-pin M12 A-coding)	
Power		

TGAP-620+-M12

IP-67/ EN50155 Wireless Access Point

Redundant Input Power	Dual Power Inputs. 12~48 VDC on 5-pin M23 connector (24 VDC Typ.)	
Power Consumption (Typ.)	8W	8.5W
Overload Current Protection	Present	
Reverse Polarity Protection	Present	
Physical Characteristic		
Enclosure	IP-40	
Dimension (W x D x H)	125.6(W) x 65(D) x 196.1(H) mm (4.94 x 2.55 x 7.72 inch.)	
Weight (g)	955g	960g
Environmental		
Storage Temperature	-40 to 85°C (-40 to 185°F)	
Operating Temperature	-25 to 70°C (-13 to 158°F)	
Operating Humidity	5 to 95% Non-condensing	
Regulatory approvals		
EMI	FCC Part 15, CISPR (EN55022) class A, EN50155 (EN50121-3-2)	
EMS	EN61000-4-2 (ESD), EN61000-4-3 (RS), EN61000-4-4 (EFT), EN61000-4-5 (Surge), EN61000-4-6 (CS), EN61000-4-8, EN61000-4-11	
Shock	IEC60068-2-27, EN61373	
Free Fall	IEC60068-2-31	
Vibration	IEC60068-2-6, EN61373	
Rail Traffic	EN50155	
Cooling	EN60068-2-1	
Dry Heat	En60068-2-2	
Safety	EN60950-1	
Warranty	5 years	

Ordering Information

TGAP-**A****B****0****C**-M12

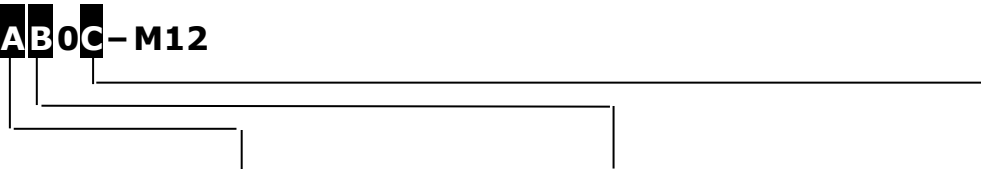

Code Definition	Wireless Mode	10/100/1000 Base-T(X) Port Number	PoE Identification
Option	- 1: 802.11 b/g - 2: 802.11 a - 3: 802.11 a/b/g - 4: 802.11 b/g/n - 5: 802.11 a/n - 6: 802.11 a/b/g/n	- "2": 2 ports	- "++": PoE P.D. present at ETH2

	Model Name	Description
Available Model	TGAP-620-M12_US	Industrial EN50155 IEEE 802.11 a/b/g/n wireless access point with 2x10/100/1000 Base-T(X), US band
	TGAP-620-M12_EU	Industrial EN50155 IEEE 802.11 a/b/g/n wireless access point with 2x10/100/1000 Base-T(X), EU band
	TGAP-620+-M12_US	Industrial EN50155 IEEE 802.11 a/b/g/n wireless access point with 2x10/100/1000 Base-T(X), 1-port PoE P.D, US band
	TGAP-620+-M12_EU	Industrial EN50155 IEEE 802.11 a/b/g/n wireless access point with 2x10/100/1000 Base-T(X), 1-port PoE P.D, EU band

Packing List

- TGAP-620-M12 x 1
- 2.4GHz/5GHz Antenna x 2
- CD x 1
- Quick Installation Guide x 1

Optional Accessories

- DR-45 series : 45 Watts power supply
- DR-120 series : 120 Watts power supply
- RF Antenna Base series
- DR-75 series : 75 Watts power supply
- WLAN RF Antenna series
- RF Cable series