

TGAR-1062+-4GS-M12

Industrial Computer Source
(Deutschland) GmbH

IP-67/EN50155 3.5/4G/LTE Cellular Router

Features

- Leading EN50155-compliant wireless access point for rolling stock application
- High Speed Air Connectivity: WLAN interface support up to 300Mbps link speed
- Highly Security Capability: WEP/WPA/WPA-PSK(TKIP,AES)/WPA2/WPA2-PSK(TKIP,AES)/802.1X Authentication supported
- Secured Management by HTTPs
- Various kind of WAN Connection Type supported: Dynamic/Static IP, PPPoE, Modem Dial Up
- IP table configurable to prevent access from unauthorized IP address
- Support VPN for secured network connection (Open VPN , PPTP VPN)
- Support NAT Setting (Virtual Server , Port Trigger , DMZ , UPnP)
- Support DHCP forwarding through PPTP function
- 4G LTE Modem dial up included
- Dual redundant Ethernet ports support Ethernet redundant mode (Recovery time < 10ms) and switch mode in M12 connector (A-coding)
- GPS support for GPS model.
- 1KV isolation for PoE P.D. port for PoE model.
- Event Warning by Syslog, Email, SNMP Trap and Relay output
- Ultra rugged enclosure for toughest industrial usages
- Wall mounting enabled



TGAR-1062+-4GS-M12

IP-67/EN50155 3.5/4G/LTE Cellular Router

Dimension

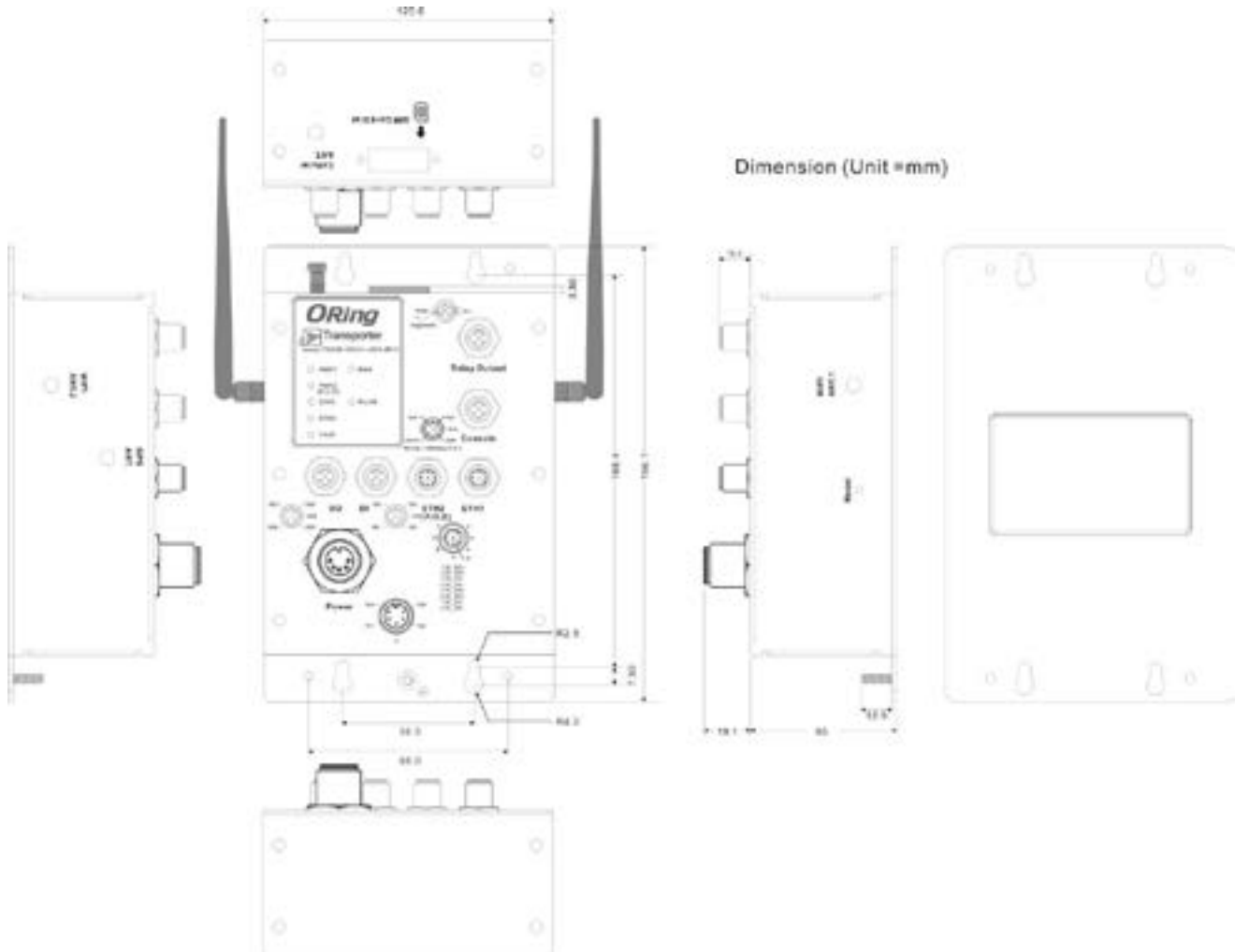

TGAR-1062+-4GS-M12

IP-67/EN50155 3.5/4G/LTE Cellular Router

Specifications

ORing EN50155 WLAN Access Point Router Model	TGAR-1062-4G-M12	TGAR-1062+-4G-M12	TGAR-1062+-4GS-M12
Physical Ports			
10/100/1000Base-T(X) Ports in M12 Auto MDI/MDIX (8-pin A-coding)	2	2(Present at ETH2 Fully compliant with IEEE 802.3af PoE P.D)	
DIDO port in M12 (5-pin A-coding)	2(DI x 4 and DO x 4) : Dry Contact: On: short to GND, Off: open Wet Contact (DI to COM/GND): On: 0 to 3VDC, Off: 10 to 30VDC		
RS-232 Console port in M12 (5-pin A-coding)	115200, 8 ,N ,1		
Relay port in M12 (5-pin A-coding)	1A@24VDC		
SIM Card Slot	1		
GPS (-4GS model only)			
Antenna Connector	1 x External reverse SMA antenna connector		
Frequency	1575.42MHz		
WLAN Interface			
Antenna Connector	2 x Reverse SMA Female		
Radio Frequency Type	DSSS, OFDM		
Modulation	IEEE802.11a : OFDM with BPSK, QPSK, QAM, 64QAM IEEE802.11b: CCK, DQPSK, DBPSK IEEE802.11g: OFDM with BPSK, QPSK, 16QAM, 64QAM IEEE802.11n : BPSK, QPSK, 16-QAM, 64-QAM		
Frequency Band	America / FCC : 2.412~2.462 GHz (11 channels) 5.180~5.240 GHz & 5.745~5.825 GHz (9 channels) Europe CE / ETSI : 2.412~2.472 Ghz (13 channels) 5.180~5.240 GHz (4 channels)		
Transmission Rate	IEEE802.11b: 1 / 2 / 5.5 / 11 Mbps IEEE802.11a/g: 6 / 9 / 12 / 18 / 24 / 36 / 48 / 54 Mbps IEEE801.11n: up to 300Mbps		
Transmit Power	802.11a: 12dBm ± 1.5dBm@54Mbps 802.11b: 17dBm ± 1.5dBm@11Mbps 802.11g: 16dBm ± 1.5dBm@54Mbps 802.11gn HT20: 15dBm ± 1.5dBm @MCS7 802.11gn HT40: 14dBm ± 1.5dBm @MCS7 802.11an HT20: 12dBm ± 1.5dBm @MCS7 802.11an HT40: 11dBm ± 1.5dBm @MCS7		
Receiver Sensitivity	802.11a : -76dBm ± 2dBm@54Mbps 802.11b : -85dBm ± 2dBm@11Mbps 802.11g : -76dBm ± 2dBm@54Mbps 802.11gn HT20:-75dBm ± 2dBm@MCS7 802.11gn HT40:-72dBm ± 2dBm@MCS7 802.11an HT20:-74dBm ± 2dBm@MCS7 802.11an HT40:-71dBm ± 2dBm@MCS7		
Encryption Security	WEP: (64-bit ,128-bit key supported) WPA/WPA2 :802.11i(WEP and AES encryption) WPAPSK (256-bit key pre-shared key supported) 802.1X Authentication supported TKIP encryption		
Wireless Security	SSID broadcast disable		
Cellular Interface			
Cellular Standard	GSM / GPRS/ EGPRS/ EDGE / WCDMA / HSDPA / HSUPA /HSPA+ /LTE		
Antenna Connector	1 x SMA Female		
Band Option	America(US) LTE: 1900(B2)/1700(B4)/850(B5)/700(B13)/700(B17)/1900(B25) MHz		

TGAR-1062+-4GS-M12

IP-67/EN50155 3.5/4G/LTE Cellular Router

	CDMA/EVDO rev. a/b: 800/1900 UMTS/HSDPA/HSUPA/HSPA+/DC-HSPA+: 850/900/1700/1900/2100 MHz GSM/GPRS/EDGE: 850/900/1800/1900 MHz Europe(EU) LTE: 2100(B1)/1800(B3)/2600(B7)/900(B8)/800(B20) MHz UMTS/HSDPA/HSUPA/HSPA+/DC-HSPA+: 800/850/900/1900/2100 MHz GSM/GPRS/EDGE: 850/900/1800/1900 MHz		
Protocol Support			
Protocol	ARP,BOOTP, DHCP, DNS, HTTP, IP, ICMP, SNMP, TCP, UDP, RADIUS, SNMP, PPPoE		
LED Indicators			
Power Indicator	2 x LEDs, PW1:Green for DC Power on PW2:Green for DC Power on or power by PoE		
10/100/1000Base-T(X) port Indicator	2 x LEDs, Green for port Link/Act		
WLAN LED	1 x LED, Green for WLAN Link/Act		
WAN LED	1 x LEDs, Green for functioning normal		
Fault Indicator	1 x LED, Red for Ethernet link down or power down indicator		
Fault Contact			
Relay	Relay output to carry capacity of 3A at 24VDC		
Power			
Redundant Input Power	Dual Power Inputs. 12~48 VDC on M23 connector (24 VDC Typ.)		
Power Consumption (Typ.)	9.5W	10.5 Watts	10.7 Watts
Overload Current Protection	Present		
Reverse Polarity Protection	Present		
Physical Characteristic			
Enclosure	IP-40		
Dimension (W x D x H)	125.6(W) x 65(D) x 196.1(H) mm (4.94 x 2.55 x 7.72 inch.)		
Weight (g)	968g	977g	977g
Environmental			
Storage Temperature	-40 to 85°C (-40 to 185°F)		
Operating Temperature	-25 to 70°C (-13 to 158°F)		
Operating Humidity	5% to 95% Non-condensing		
Regulatory Approvals			
EMI	FCC Part 15, CISPR (EN55022) class A, EN50155 (EN50121-3-2)		
EMS	EN61000-4-2 (ESD), EN61000-4-3 (RS), EN61000-4-4 (EFT), EN61000-4-5 (Surge), EN61000-4-6 (CS), EN61000-4-8, EN61000-4-11		
Shock	IEC60068-2-27, EN61373		
Free Fall	IEC60068-2-31		
Vibration	IEC60068-2-6, EN61373		
Rail Traffic	EN50155		
Cooling	EN60068-2-1		
Dry Heat	EN60068-2-2		
Safety	EN60950-1		
Warranty	5 years		

Ordering Information

TGAR-ABCDE-FFG-M12

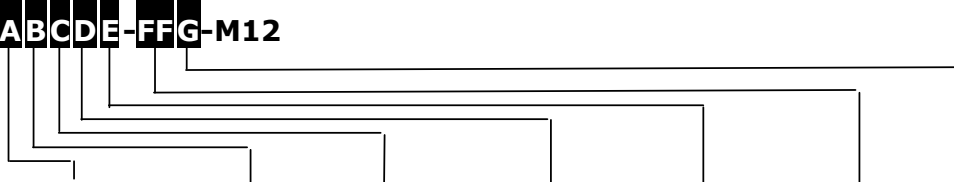

Code Definition	Cellular Module Number	2 nd Wireless Mode	1 st Wireless Mode	Giga Ethernet Port Number	PoE Identification	Cellular Generation	GPS Function
Option	1: One SIM	1: 802.11 b/g	1: 802.11 b/g	2: 2 ports	-"+": PoE P.D. present at ETH2	4G :LTE	S:GPS
	2: Dual SIM	2: 802.11 a	2: 802.11 a				
		3: 802.11 a/b/g	3: 802.11 a/b/g				
		4: 802.11 b/g/n	4: 802.11 b/g/n				
		5: 802.11 a/n	5: 802.11 a/n				
		6: 802.11 a/b/g/n	6: 802.11 a/b/g/n				

Model Name	Description
TGAR-1062-4G-M12_US	Industrial EN50155 IEEE 802.11 a/b/g/n 4G LTE cellular router with 2x10/100/1000Base-T(X), M12 connector, US band
TGAR-1062+-4G-M12_US	Industrial EN50155 IEEE 802.11 a/b/g/n 4G LTE cellular router with 2x10/100/1000Base-T(X), M12 connector, 1-port PoE P.D, US band
TGAR-1062+-4GS-M12_US	Industrial EN50155 IEEE 802.11 a/b/g/n 4G LTE cellular GPS router with 2x10/100/1000Base-T(X), M12 connector, 1-port PoE P.D, US band
TGAR-1062-4G-M12_EU	Industrial EN50155 IEEE 802.11 a/b/g/n 4G LTE cellular router with 2x10/100/1000Base-T(X), M12 connector, EU band
TGAR-1062+-4G-M12_EU	Industrial EN50155 IEEE 802.11 a/b/g/n 4G LTE cellular router with 2x10/100/1000Base-T(X), M12 connector, 1-port PoE P.D, EU band
TGAR-1062+-4GS-M12_EU	Industrial EN50155 IEEE 802.11 a/b/g/n 4G LTE cellular GPS router with 2x10/100/1000Base-T(X), M12 connector, 1-port PoE P.D, EU band

Packing List

- TGAR-1062(+)-4G(S)-M12 x 1
- CD x 1
- Quick Installation Guide x 1
- 2.4GHz/5GHz Antenna x 2
- Cellular LTE Antenna x 1

Optional Accessories

- DR-45 series : 45 Watts power supply
- DR-75 series : 75 Watts power supply
- DR-120 series : 120 Watts power supply
- WLAN RF Antenna series
- RF Antenna Base series
- RF Cable series