

TGAR-2062+-3GS-M12

Industrial Computer Source
(Deutschland) GmbH

IP-67/EN50155 3.5/4G/LTE Cellular Router

Features

- Leading EN50155-compliant wireless access point for rolling stock application
- High Speed Air Connectivity: WLAN interface support up to 300Mbps link speed
- Highly Security Capability: WEP/WPA/WPA-PSK(TKIP,AES)/WPA2/WPA2-PSK(TKIP,AES)/802.1X Authentication supported
- Secured Management by HTTPS
- **Support dual 3.5G HSDPA dial up backup and load balance**
- Various kind of WAN Connection Type supported: Dynamic/Static IP, PPPoE, Modem Dial Up
- IP table configurable to prevent access from unauthorized IP address
- Support VPN for secured network connection (Open VPN , PPTP VPN)
- Support NAT Setting (Virtual Server , Port Trigger , DMZ , UPnP)
- Support DHCP forwarding through PPTP function
- Dual redundant Ethernet ports support Ethernet redundant mode (Recovery time < 10ms) and switch mode in M12 connector (A-coding)
- GPS support for GPS model
- 1KV isolation for PoE P.D. port for PoE model.
- Event Warning by Syslog, Email, SNMP Trap and Relay output
- Ultra rugged enclosure for toughest industrial usages
- Wall mounting enabled



TGAR-2062+-3GS-M12

IP-67/EN50155 3.5/4G/LTE Cellular Router

Dimension

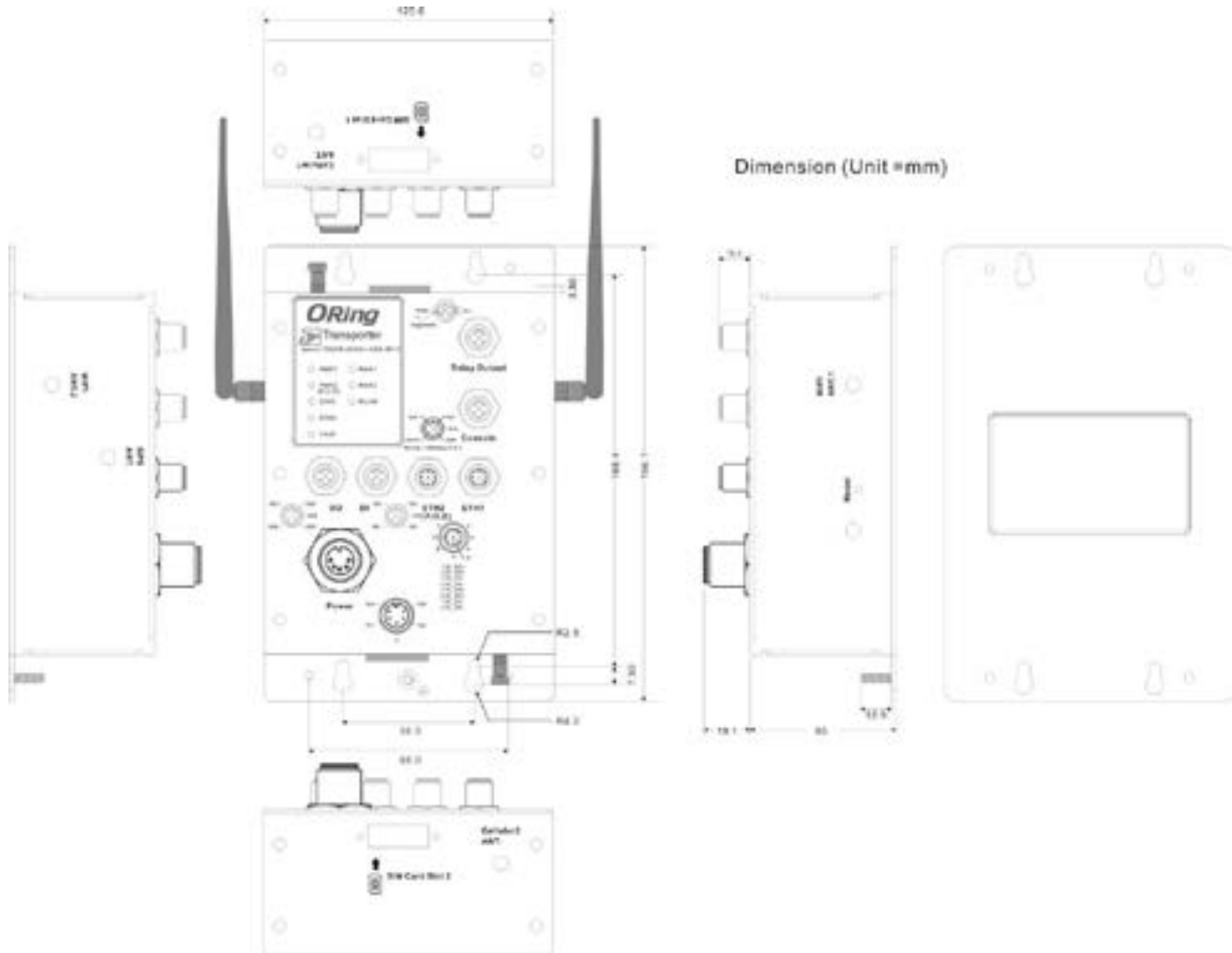

TGAR-2062+-3GS-M12

IP-67/EN50155 3.5/4G/LTE Cellular Router

Specifications

ORing EN50155 WLAN Access Point Router Model	TGAR-2062-3G-M12	TGAR-2062+-3G-M12	TGAR-2062+-3GS-M12
Physical Ports			
10/100/1000Base-T(X) Ports in M12 Auto MDI/MDIX (8-pin A-coding)	2	2(Present at ETH2 Fully compliant with IEEE 802.3af PoE P.D)	
DIDO port in M12 (5-pin A-coding)	2(DI x 4 and DO x 4) Dry Contact: On: short to GND, Off: open Wet Contact (DI to COM/GND): On: 0 to 3VDC, Off: 10 to 30VDC		
RS-232 Console port in M12 (5-pin A-coding)	115200, 8 , N , 1		
Relay port in M12 (5-pin A-coding)	1A@24VDC		
SIM Card Slot	2		
WLAN Interface			
Antenna Connector	2 x Reverse SMA Female		
Radio Frequency Type	DSSS, OFDM		
Modulation	IEEE802.11a : OFDM with BPSK, QPSK, QAM, 64QAM IEEE802.11b: CCK, DQPSK, DBPSK IEEE802.11g: OFDM with BPSK, QPSK, 16QAM, 64QAM IEEE802.11n : BPSK, QPSK, 16-QAM, 64-QAM		
Frequency Band	America / FCC : 2.412~2.462 GHz (11 channels) 5.180~5.240 GHz & 5.745~5.825 GHz (9 channels) Europe CE / ETSI : 2.412~2.472 Ghz (13 channels) 5.180~5.240 GHz (4 channels)		
Transmission Rate	IEEE802.11b: 1 / 2 / 5.5 / 11 Mbps IEEE802.11a/g: 6 / 9 / 12 / 18 / 24 / 36 / 48 / 54 Mbps IEEE801.11n: up to 300Mbps		
Transmit Power	802.11a: 12dBm ± 1.5dBm 802.11b: 18dBm ± 1.5dBm 802.11g: 15dBm ± 1.5dBm 802.11gn HT20: 13dBm ± 1.5dBm@150Mbps 802.11gn HT40: 12dBm ± 1.5dBm@300Mbps 802.11an HT20: 12dBm ± 1.5dBm@150Mbps 802.11an HT40: 12dBm ± 1.5dBm@300Mbps		
Receiver Sensitivity	802.11a: -68dBm ±2dBm@54Mbps 802.11b: -85dBm ±2dBm@11Mbps 802.11g: -68dBm ±2dBm@54Mbps 802.11gn HT20: -68dBm ±2dBm@150Mbps 802.11gn HT40: -68dBm ±2dBm@300Mbps 802.11an HT20: -68dBm ±2dBm@150Mbps 802.11an HT40: -68dBm ±2dBm@300Mbps		
Encryption Security	WEP: (64-bit ,128-bit key supported) WPA/WPA2 :802.11i(WEP and AES encryption) WPAPSK (256-bit key pre-shared key supported) 802.1X Authentication supported TKIP encryption		
Wireless Security	SSID broadcast disable		
Cellular Interface			
Cellular Standard	GSM / GPRS/ EGPRS/ EDGE / WCDMA / HSDPA / HSUPA		
Antenna Connector	2 x Reverse SMA Female		
Band Option	Dual-band : HSUPA 1900/2100 MHz Quad-band : GSM/GPRS/EDGE 850/900/1800/1900 MHz WCDMA/HSDPA 850/900/1900/2100 MHz		
Protocol Support			
Protocol	ARP,BOOTP, DHCP, DNS, HTTP, IP, ICMP, SNMP, TCP, UDP, RADIUS, SNMP, PPPoE		
LED Indicators			

TGAR-2062+-3GS-M12

IP-67/EN50155 3.5/4G/LTE Cellular Router

Power Indicator	2 x LEDs, Green for Power on		
10/100/1000Base-T(X) port Indicator	2 x LEDs, Green for port Link/Act		
WLAN LED	1 x LED, Green for WLAN Link/Act		
WAN LED	2 x LEDs, Green for functioning normal		
Fault Indicator	1 x LED, Red for Ethernet link down or power down indicator		
Fault Contact			
Relay	Relay output to carry capacity of 1A at 24VDC		
Power			
Redundant Input Power	Dual Power Inputs. 12~48 VDC on M23 connector (24 VDC Typ.)		
Power Consumption (Typ.)	13 Wait	14 Wait	14.2 Wait
Overload Current Protection	Present		
Reverse Polarity Protection	Present		
Physical Characteristic			
Enclosure	IP-40		
Dimension (W x D x H)	125.6(W) x 65(D) x 196.1(H) mm (4.94 x 2.55 x 7.72 inch.)		
Weight (g)	1030g	1035g	1035g
Environmental			
Storage Temperature	-40 to 85°C (-40 to 185°F)		
Operating Temperature	-25 to 70°C (-13 to 158°F)		
Operating Humidity	5% to 95% Non-condensing		
Regulatory Approvals			
EMI	FCC Part 15, CISPR (EN55022) class A, EN50155 (EN50121-3-2)		
EMS	EN61000-4-2 (ESD), EN61000-4-3 (RS), EN61000-4-4 (EFT), EN61000-4-5 (Surge), EN61000-4-6 (CS), EN61000-4-8, EN61000-4-11		
Shock	IEC60068-2-27, EN61373		
Free Fall	IEC60068-2-31		
Vibration	IEC60068-2-6, EN61373		
Rail Traffic	EN50155		
Cooling	EN60068-2-1		
Dry Heat	EN60068-2-2		
Safety	EN60950-1		
Warranty	5 years		

Ordering Information

TGAR-**A****B****C****D****E**-**F****F****G**-M12

Code Definition	Cellular Module Number	2 nd Wireless Mode	1 st Wireless Mode	Giga Ethernet Port Number	PoE Identification	Cellular Generation	GPS Function
Option	1: One SIM 2: Dual SIM	1: 802.11 b/g 2: 802.11 a 3: 802.11 a/b/g 4: 802.11 b/g/n 5: 802.11 a/n 6: 802.11 a/b/g/n	1: 802.11 b/g 2: 802.11 a 3: 802.11 a/b/g 4: 802.11 b/g/n 5: 802.11 a/n 6: 802.11 a/b/g/n	2: 2 ports	-"+": PoE P.D. present at ETH2	3G :UMTS	S:GPS

Model Name	Description
TGAR-2062-3G-M12_US	Industrial EN50155 IEEE 802.11 a/b/g/n Dual 3G cellular router with 2x10/100/1000Base-T(X), M12 connector, US band
TGAR-2062+-3GS-M12_US	Industrial EN50155 IEEE 802.11 a/b/g/n Dual 3G cellular router with 2x10/100/1000Base-T(X), M12 connector, 1-port PoE P.D, US band
TGAR-2062+-3GS-M12_US	Industrial EN50155 IEEE 802.11 a/b/g/n Dual 3G cellular GPS router with 2x10/100/1000Base-T(X), M12 connector, 1-port PoE P.D, US band
TGAR-2062-3G-M12_EU	Industrial EN50155 IEEE 802.11 a/b/g/n Dual 3G cellular router with 2x10/100/1000Base-T(X), M12 connector, EU band
TGAR-2062+-3GS-M12_EU	Industrial EN50155 IEEE 802.11 a/b/g/n Dual 3G cellular router with 2x10/100/1000Base-T(X), M12 connector, 1-port PoE P.D, EU band
TGAR-2062+-3GS-M12_EU	Industrial EN50155 IEEE 802.11 a/b/g/n Dual 3G cellular GPS router with 2x10/100/1000Base-T(X), M12 connector, 1-port PoE P.D, EU band

Packing List

- TGAR-2062(+)-3G(S)-M12 x 1
- CD x 1
- Quick Installation Guide x 1
- 2.4GHz/5GHz Antenna x 2
- 3G Antenna x 2
- GPS Antenna (GPS model)

Optional Accessories

- DR-45 series : 45 Watts power supply
- DR-75 series : 75 Watts power supply
- DR-120 series : 120 Watts power supply
- WLAN RF Antenna series
- RF Antenna Base series
- RF Cable series